



Maxi
78'

Maxi 78'





AN EXCEPTIONAL WORLD, THE WORLD OF ULTIMATE REQUIREMENT

Yachts built for enthusiasts, by enthusiasts. This enthusiasm, is that of the intelligent choice of materials, the strength of the ideas, the esthetics. It is timeless, beautiful and strong as the sea.

The boatyard exclusively employs a skilled craftsmen. Their know-how, associated with adequate technical means, allows them to achieve an exceptional construction quality. Their philosophy, is the total mastery of the different building steps, and the adoption of a rigorous methodology, to achieve the required result :

- *foremost technology for all major parts guaranteeing an irreproachable reliability*
- *craftsmen's skills for the perfect finish.*
- *use of noble materials ensuring a*



Luxury and perfectionism ...



... one of the C.I.M. shipyard's finest jewel, the MAXI 88'

luxurious and personalized esthetic. ■ draconian respect for the specifications, from the design to sea trials. So much added value that guarantees the total delight of trouble free sailing for the owners of C.I.M. maxi-yachts : a voluptuous mixture of sweet and salty, of spray and satin. ■

Lively and elegant, the *MAXI 78'* is an exceptional sailing yacht. Powerful bow, racer lines, its large width at the waterline gives it excellent form stability and generous accommodation.

The *MAXI 78'* exists in two different versions.

■ The "performance" version, orientated towards cruiser-racing, has a deep keel and a tall rig with a fully battened main sail. Those racing sailors at heart will be thrilled by the sweet sensation of gentle and certain power implied by the acceleration of the yacht in each gust. ■ The

"cruiser" version is destined to those who prefer comfort and simple manoeuvring above all. Sails set on roller furlers, reduced draft, a conception based around the pleasure of easy and relaxed sailing. Racing, or an around the world trip, the *MAXI 78'* will fulfill your hearts desire. ■



et si tel est le cas, sachez que le hasard n'y est pour rien !..."

Olivier Flahault

"Un maxi-yacht a le devoir, à mes yeux, d'être beau, élégant et racé !..."

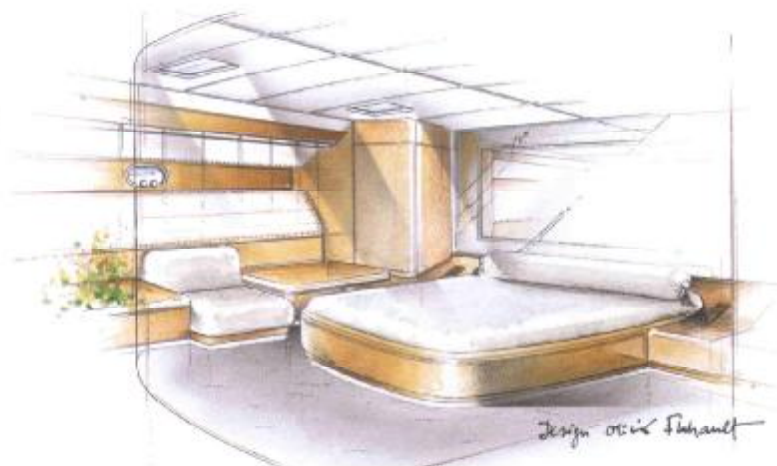

The "owner" version has a large private suite and two guest cabins.





- *Each gesture is measured, adjusted.*
- *The tool, from the simplest to the most sophisticated, always essential and highly proficient, is at the service of man's skills and capabilities.*
- *With its organisation and industrial structure, the C. I. M. shipyard can produce up to 4 units at a time, always with the highest quality of construction.*
- *For several years now, his drawings have taken their place amongst the best and his office is one of the best in the world : New-zealand's Bruce FARR has designed, for the MAXI 78' quite exceptional lines.*



**Bureau
Veritas**

- *Bureau Veritas has given MAXI 78' the highest classification degree.*

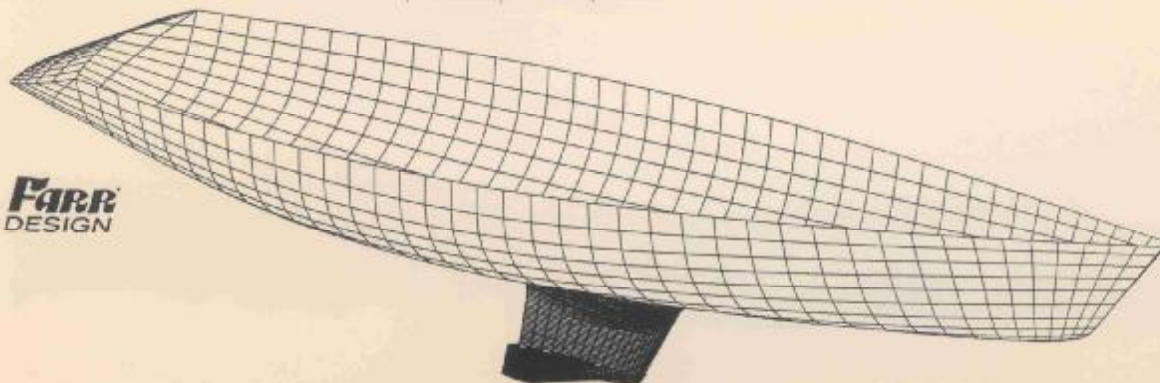
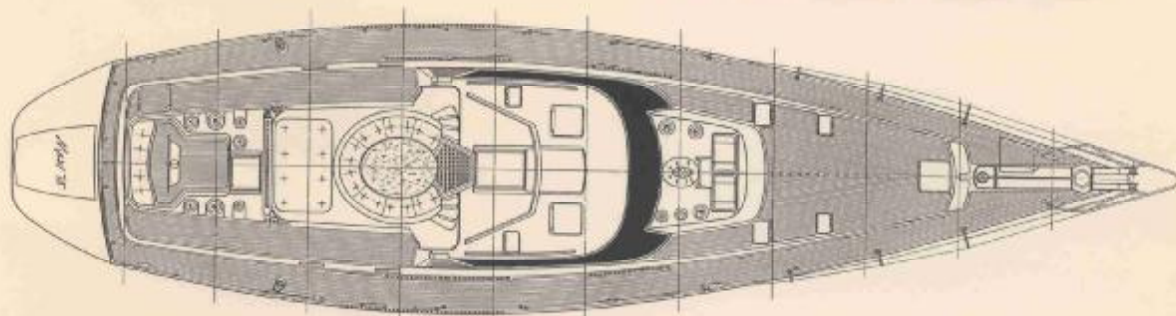

FARR
DESIGN





Owner
version

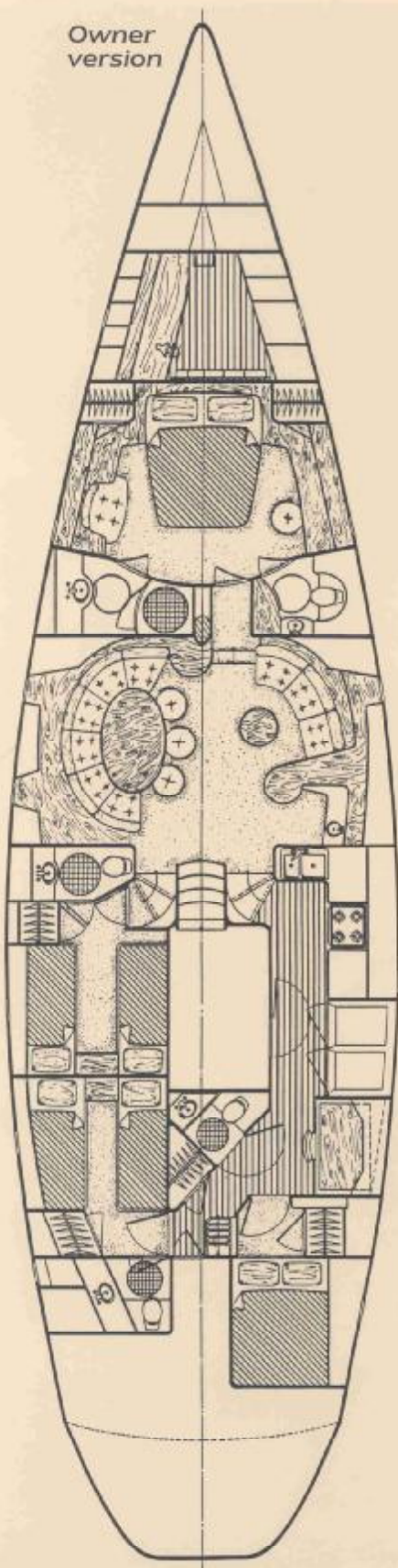

Charter
version

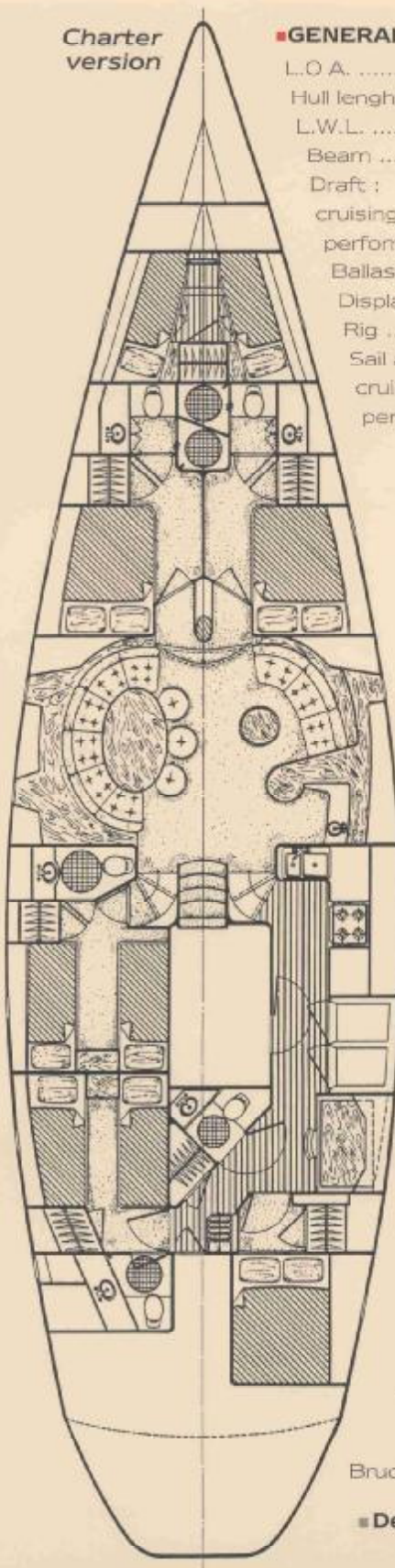

■ GENERAL DESCRIPTION

| | |
|--------------------|---------|
| L.O.A. | 24,30 m |
| Hull length | 23,80 m |
| L.W.L. | 19,76 m |
| Beam | 6,28 m |
| Draft : | |
| cruising | 2,80 m |
| performance | 3,80 m |
| Ballast | 15 mt |
| Displacement | 40 mt |
| Rig | Cutter |
| Sail area : | |
| cruising | 267 sqm |
| performance | 332 sqm |

Maxi 78'

■ Building materials :
Laminated polyester
resin/fiberglass
P.V.C. foam cores

■ Classification :
Bureau Veritas,
Cote Φ 1 3/3 E
CHARTER YACHT C

■ Approval :
Merchant Marine, NUC,
1st category of navigation

■ Architects :
Bruce FARR AND ASSOCIATES

■ Designer : Olivier FLAHAULT



Maxi 78'



CONSTRUCTIONS INDUSTRIELLES ET MARITIMES



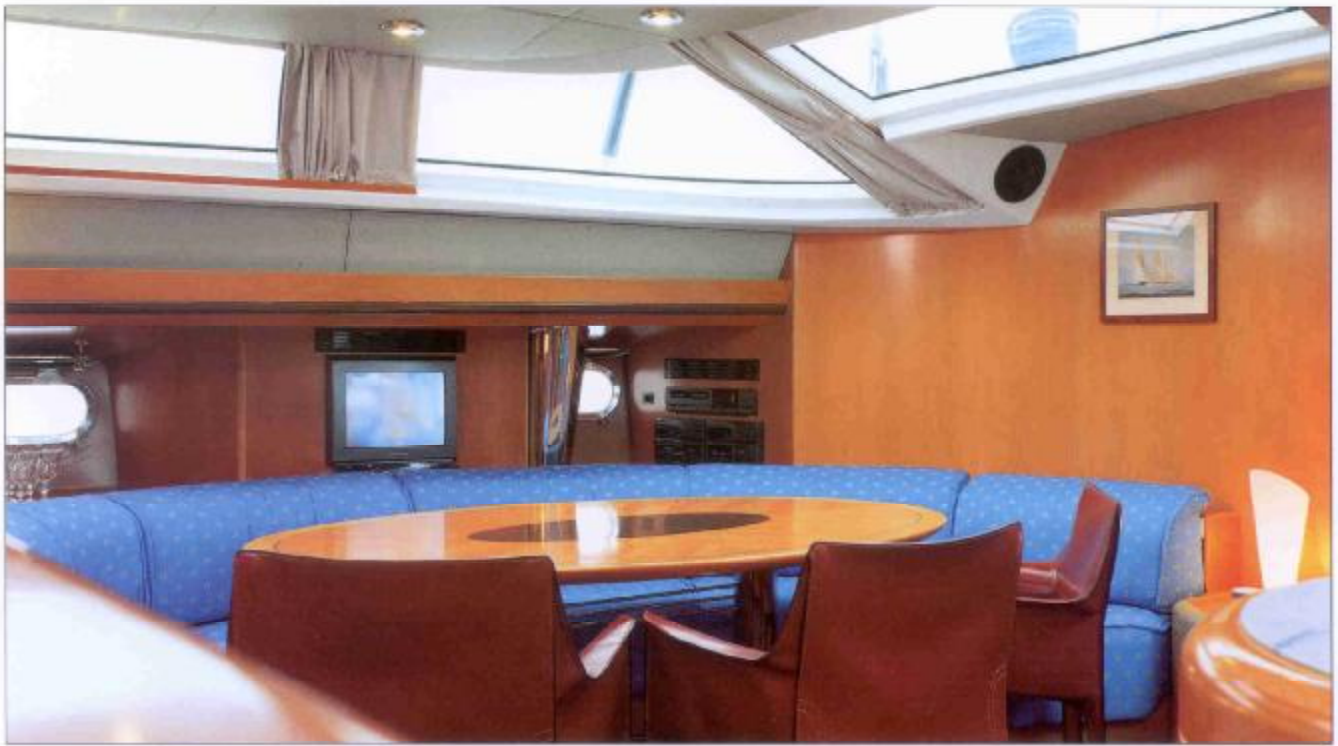

Maxi 78'



CONSTRUCTIONS INDUSTRIELLES ET MARITIMES



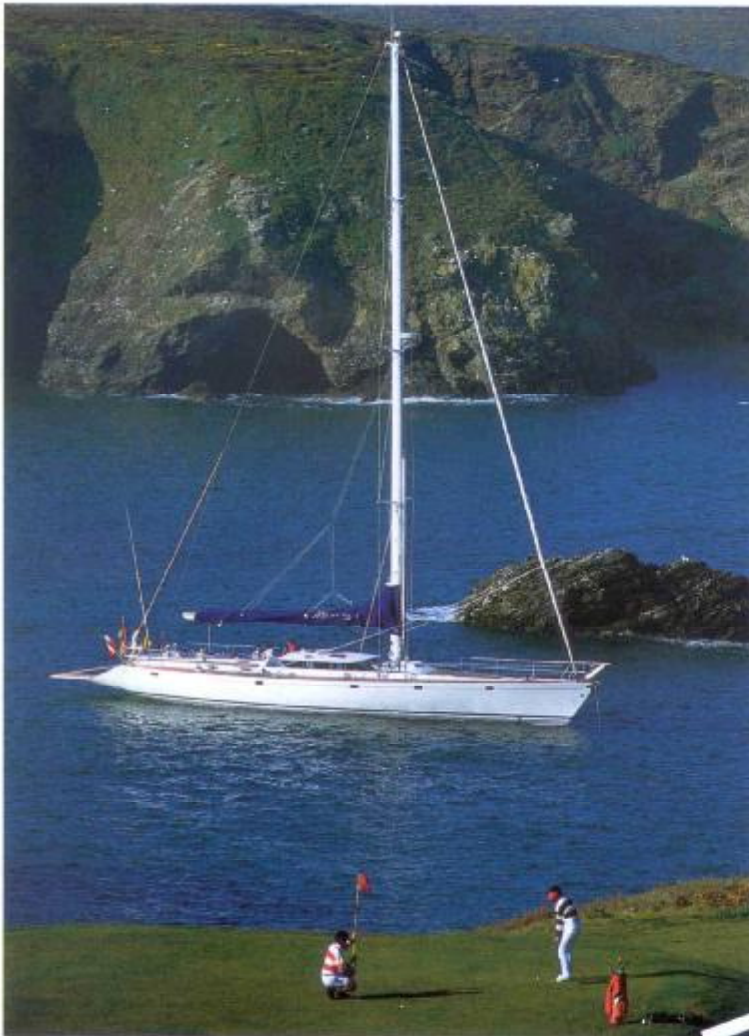

Maxi 78'



CONSTRUCTIONS INDUSTRIELLES ET MARITIMES





CONSTRUCTIONS INDUSTRIELLES ET MARITIMES
Zone Industrielle du Canal des Sœurs - 17300 ROCHEFORT - FRANCE
Tél. 46.99.54.51 - Fax. 46.99.78.03 - Télex 791 802